

# U-SELECT-IT CORP.

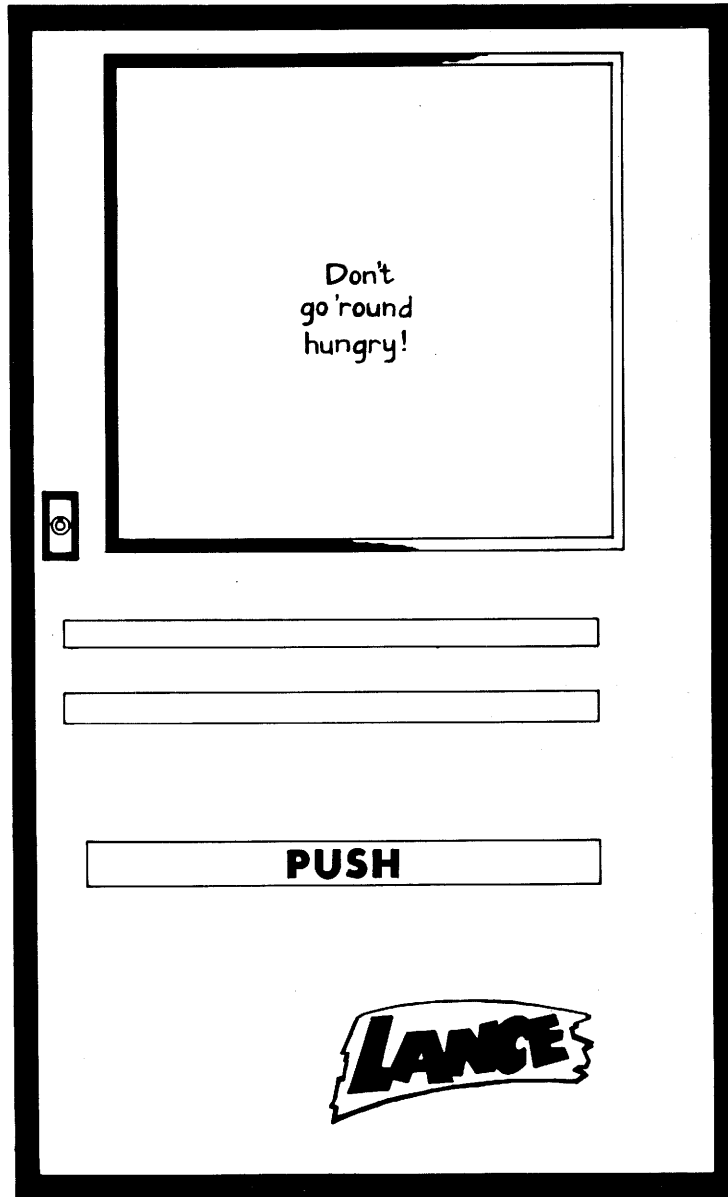

## Service & Parts Manual for LANCE DROP SHELF VENDOR

# TABLE OF CONTENTS

Forward .....	2
Specifications .....	2
Installation .....	2
Price Setting .....	3-4
Product Loading .....	3
Free Play Lever .....	3-4
Quarter Restriction Adjustment .....	5
Display Area Product Loading .....	6
Stack Removal & Installation .....	7
Trouble Shooting .....	8-9-10
Care & Cleaning .....	10
Slug Ejector .....	10
Unit Final Assembly .....	11
Parts List .....	12
Door Final Assembly .....	13
Parts List .....	14
Mech Final Assembly .....	15
Parts List .....	16
Right End Plate Assembly .....	17
Parts List .....	18
Stack Final Assembly — Narrow .....	19
Parts List .....	20
Stack Final Assembly — Wide .....	21
Parts List .....	22
Escrow Box Assembly and Parts List .....	23
SCS Module Front View and Parts List .....	24
SCS Module Back View and Parts List .....	25
Notes .....	26

## MANUAL INFORMATION

All part numbers in parts list marked with \* indicates same part used on Lance/USI Super Vendor.

©U-Select-II Corp. 1985  
For USI Drop Shelf  
Serial No. from 282001 to 284500

Manual Part No. 20619  
R-3 1-3-85

# FORWARD

## READ THIS BEFORE YOU BEGIN

This manual has been designed with a Hearthstone colored cover for easy identification. Read the trouble shooting section of this manual carefully before you begin any repairs on this machine.

---

## SPECIFICATIONS

CABINET	HEIGHT	62¼"
	WIDTH	38"
	DEPTH	17"
	WEIGHT	351 lbs.

**CAUTION**  
WHILE VENDOR IS IN TRANSIT SHELVES  
MUST BE IN DOWN POSITION.

COINAGE: Dual Price, Pricing — 5¢ to \$1.50 with 5¢ to 25¢ price spread from first price to second price. Accepts nickels, dimes or quarters in any combination.  
**DOES NOT** Make Change.

---

## INSTALLATION

1. To remove carton, remove all banding around the machine. Slide carton up to remove.
2. Remove all inner packing and tape.
3. Remove wood pallet from under the vendor. Turn the levelers in as far as possible.
4. Place vendor in desired location. **VENDOR MUST BE LEVEL.** To level vendor adjust levelers so machine is level and does not rock or teeter on any leveler. The levelers provided may be turned under cabinet or inside cabinet.
5. Vendor may be anchored to the floor by removing the plastic snap in hole plugs, located on floor inside cabinet.

### 6. DELIVERY DOOR SETTING

After vendor is in location and level. Adjust delivery door to desired opening height by following Step 1 or Step 2.

STEP 1.) **Free Swinging Door:** Moving bracket (A) up or down in slot (D) will adjust delivery door opening.

STEP 2.) **Stationary Door:** Insert screw (B) through bracket (A) into hole (C) will make delivery door stationary. Opening height adjusted by following Step 1.

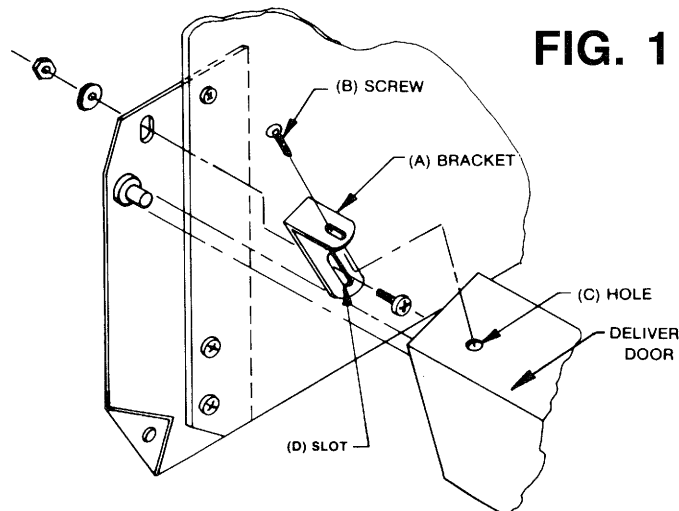

# PRICE SETTING

## FIRST (LOW) PRICE SETTING

- STEP 1.) Remove coinage unit  
a.) Remove thumb screw (A) at top of coinage unit.  
b.) Pull back coinage latch far enough to allow coinage unit to swing to the right. After clearing latch lift coinage straight up and pull out toward you.
- STEP 2.) The first (low) price wire (B) will always remain in the "0" slot of the wire guide. The low price will always be at least 5¢ less than high price.
- STEP 3.) After removal of coinage set first price by loosening screw (C). (Do not remove completely) then rotate price wheel until desired price appears centered in price window. The price in window will be the first (low) price only.
- STEP 4.) Retighten screw (C) until price wheel is firmly in place. **(DO NOT OVER TIGHTEN)**
- STEP 5.) Replace coinage to original position. Secure with thumb screw (A). When replacing coinage make sure reset arm is depressed so price wheel is in zero credit position.

## SECOND (HIGH) PRICE SETTING

- STEP 1.) Remove tab (H) to operate Second Price
- STEP 2.) Loosen wingnut on wire retainer, raise retainer as high as slot will allow. Retighten wingnut to hold retainer in place while following steps 2 thru 4 below. Each slot away from "0" slot represents one nickle advance in price from the first (low) price. Price wire (B) always remains in "0" slot.
- STEP 3.) Loosen Bolt (D) to move wire (E) out of wire guide slot and move to desired price slot.
- STEP 4.) Insert coins equal to second price. When high price setting is on coinage make sure price wheel is 1/32 to 1/16 underneath price wire (E). After setting wire (E) retighten bolt (D).
- STEP 5.) Return wire retainer over wire guide and retighten wingnut.
- STEP 6.) For each selection to vend at second (high) price. Remove screw (G) in Fig. 2 from price change bar and turn price change finger over as shown. Replace screw (G) securely.
- STEP 7.) **DO NOT** use price change finger(s) for selection(s) vending at first (low) price.
- 

# PRODUCT LOADING

**ALWAYS** load product to match product on display. After selection is sold out and stack is empty to reset shelves follow steps 1 & 2.

- STEP 1.) Shelf lift, located to the left of each stack is to be pulled out. Pull shelf lift out until it stops. Release lift. By doing this the first shelf is now locked into horizontal position.
- STEP 2.) After first shelf is locked in position run finger up the front of all the shelves left in stack. Make sure each shelf locks into horizontal position as they are lifted.
- STEP 3.) When partially loading of a particular selection, load stack from top shelf down. If there is no product on a shelf it must be in down position. This is accomplished by using free play lever and pulling selection knob.
- STEP 4.) To rotate product when reloading a selection that still has product left in stack. Set all shelves in horizontal position. Take product remaining in the upper shelves and place in lower shelves. This will always allow customer to receive fresh product.
- 

## FREE PLAY LEVER

Free play lever (shown on Page 4 Fig. 3) can be pushed and held down for free playing any selection.

**FIG. 2**

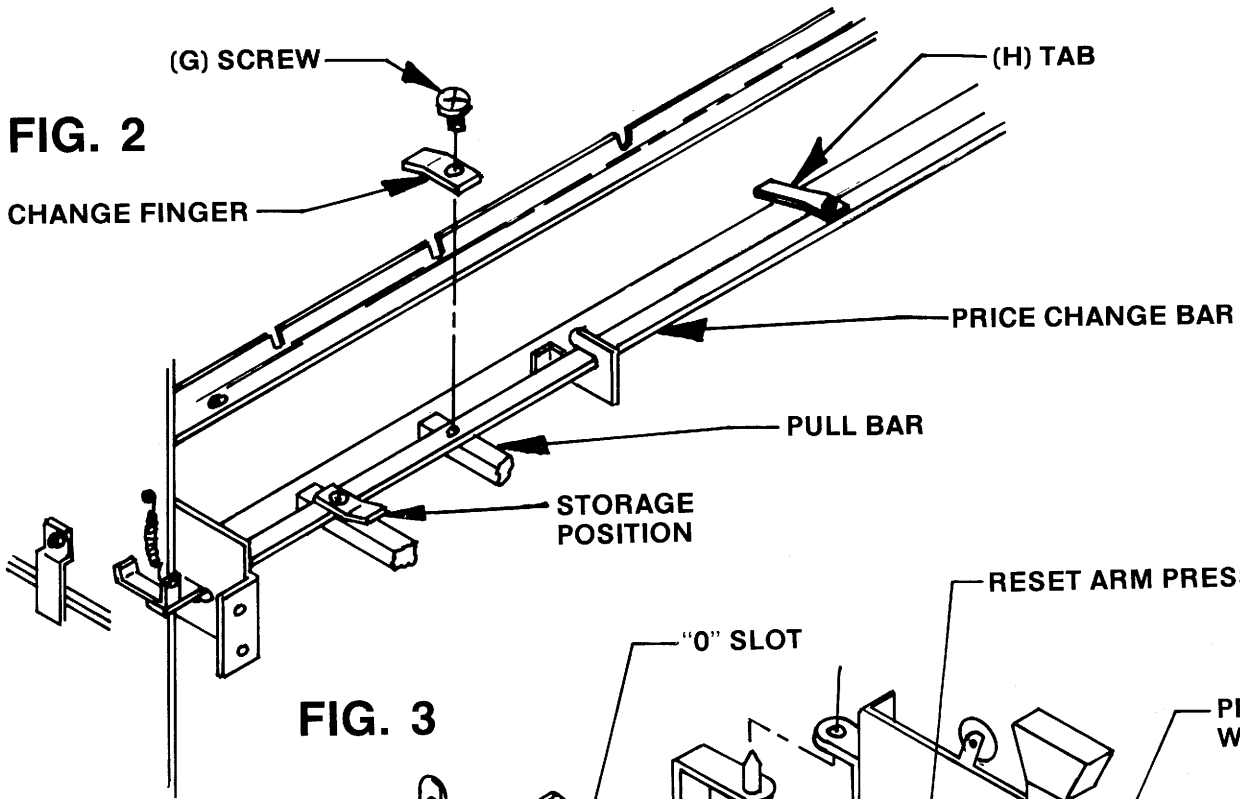

**FIG. 3**

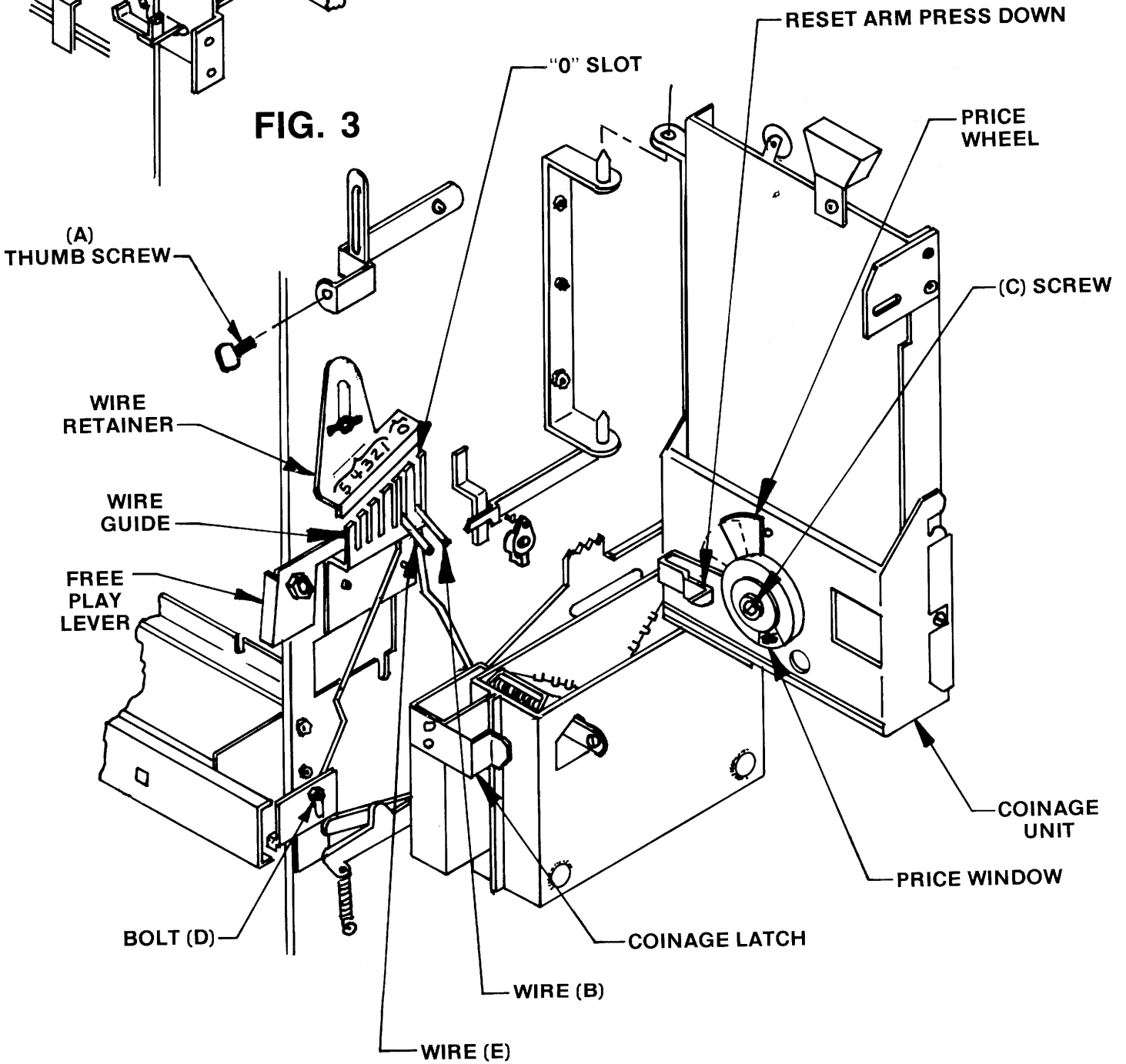

## QUARTER RESTRICTION ADJUSTMENT

Quarters may be restricted from being inserted into the coin entry slot, if desired. This adjustment is only necessary if all product vends for 20¢ or less.

STEP 1.) Loosen all hex nuts, except the ones on the coin reject knob.

STEP 2.) Slide coin insert backing plate weld assembly to the middle of slots. This will shorten opening of the coin entry slot, preventing acceptance of quarters.

STEP 3.) Retighten all hex nuts.

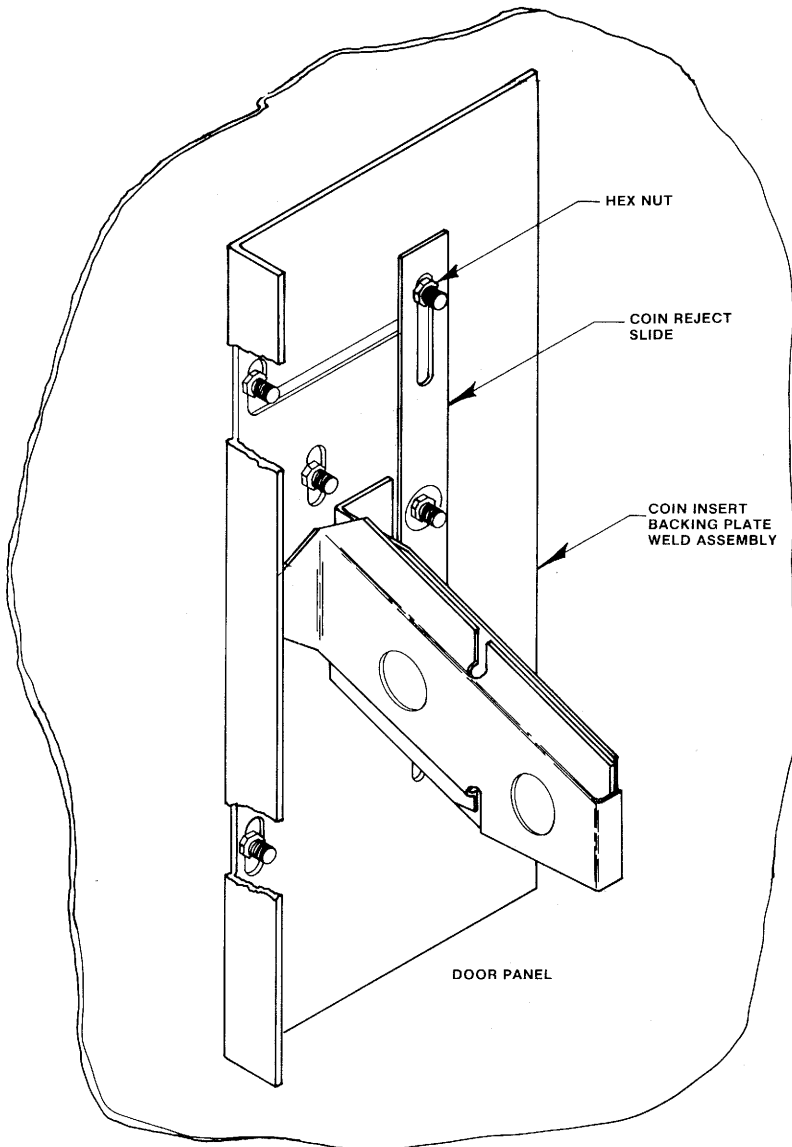

---

## COIN INSERT BACKING PLATE WELD ASSEMBLY

The coin insert backing plate weld assembly may be installed in any dropshelf (2058) that is on location now. It will be installed on all machines that leave the plant. To install in an existing machine you would first have to remove (Items 35, 34 & 20 Page 13) of the manual. Place coin insert backing plate weld assembly in place over the weld studs on the coin insert plate, and fasten in place by putting all the parts back on the machine that you removed except for (Item 20 Page 13).

# DISPLAY AREA

## NARROW PRODUCT DISPLAY LOADING

- STEP 1.) Open display door by pushing side of display box as indicated by label. Pull product retainer wire (A) out and away from display door far enough to slip product behind wire.
- STEP 2.) Release retainer wire slowly. **Do Not** allow retainer wire to snap against product.
- STEP 3.) When product is in place, select desired price.
- STEP 4.) Place price tag on item selection no. tag (B).
- STEP 5.) Place Tag (B) over Tab (C) as shown in Fig. 4.
- NOTE 1.) Price tag and item selection No. Tag (B) are placed in coin box for shipping.
- NOTE 2.) Rotate product occasionally for better looking display.

FIG. 4

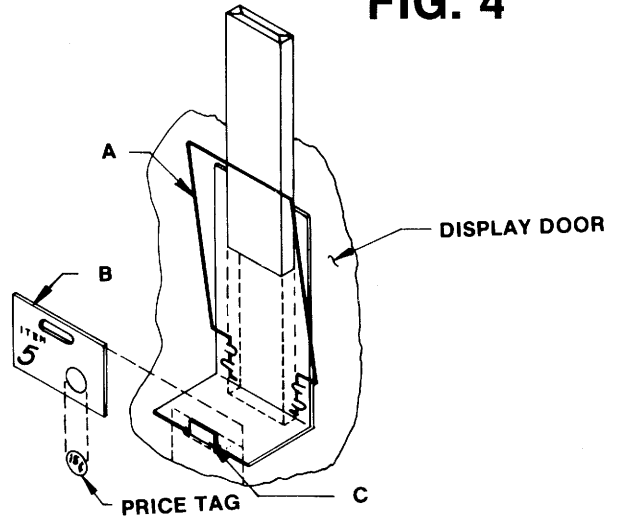
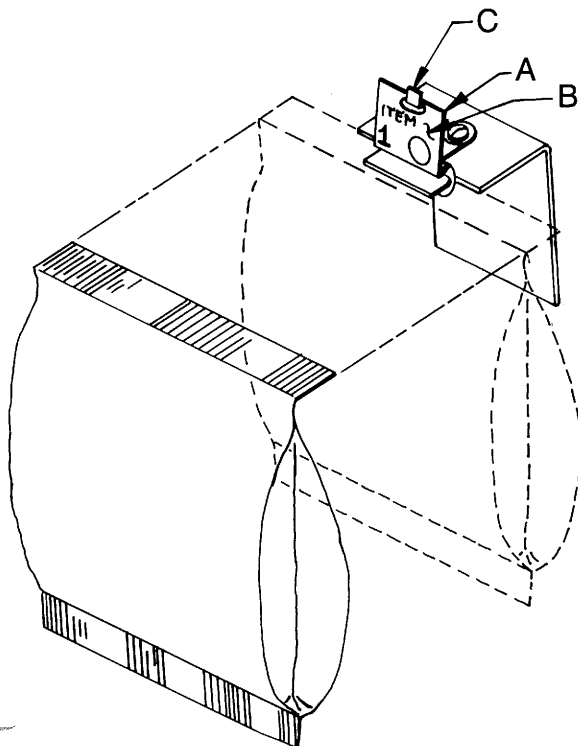

FIG. 5



## BAG PRODUCT DISPLAY LOADING

- STEP 1.) Push open hinged Tab (A) far enough to insert top edge of bag.
- STEP 2.) Release Tab (A) to allow hinge to hold bag in place.
- STEP 3.) To set price on bag selections, follow step 3 thru 5 on narrow product display loading.
- NOTE 1.) Price tag and item selection no. tag are placed in coin box for shipping.
- NOTE 2.) Rotate product occasionally for better looking display.

## STACK REMOVAL

- STEP 1.) Make sure all shelves are down in stack to be removed.
- STEP 2.) Loosen wing screw to allow stack hold down to slide on top of top back brace.
- STEP 3.) Hold stack side plate and lift stack up high enough to release stack from top back brace.
- STEP 4.) Tilt top of stack toward you and lift stack up and out.

## STACK INSTALLATION

- STEP 1.) When installing stack, make sure all shelves are in up position.
- STEP 2.) Line up parts 1, 2 & 3 then follow steps 2 thru 4 above in reverse.

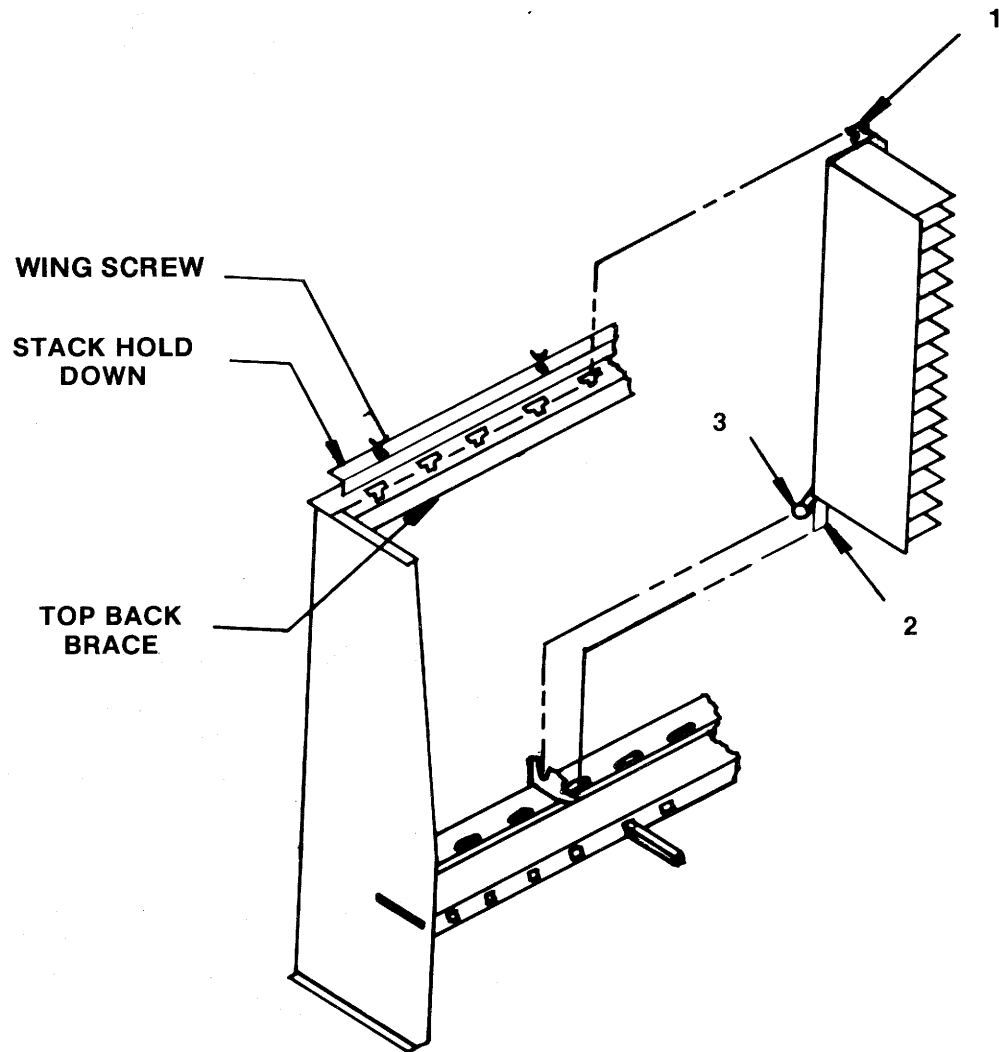



# TROUBLE SHOOTING

## I. VENDOR REJECTS ALL COINS

- A. Machine not level - Level machine (See Page 2, INSTALLATION).
- B. Dirty rejector - Clean rejector.
- C. Defective rejector - Repair or replace.
- D. Coin(s) lodged in rejector - Remove Canadian or bent coin(s).

## II. ACCEPTS COIN(S) BUT WILL NOT ESTABLISH CREDIT.

- A. Coin(s) lodged in rejector - Remove lodged coin(s).
- B. Coin(s) lodged in coin chute - Remove lodged coin(s).
- C. Coin chute out of alignment - Align coin chute with coin funnel on coin mech.
- D. Defective coinage - Repair or replace coinage.
- E. Rejector reset lever assembly adjusted to low and resting on reset on coinage
  - 1. Make sure coinage is in proper location.
  - 2. Adjust rejector reset assembly by increasing the amount of threads shown on top of (Item 26, Page 17).

ILLUSTRATION 1

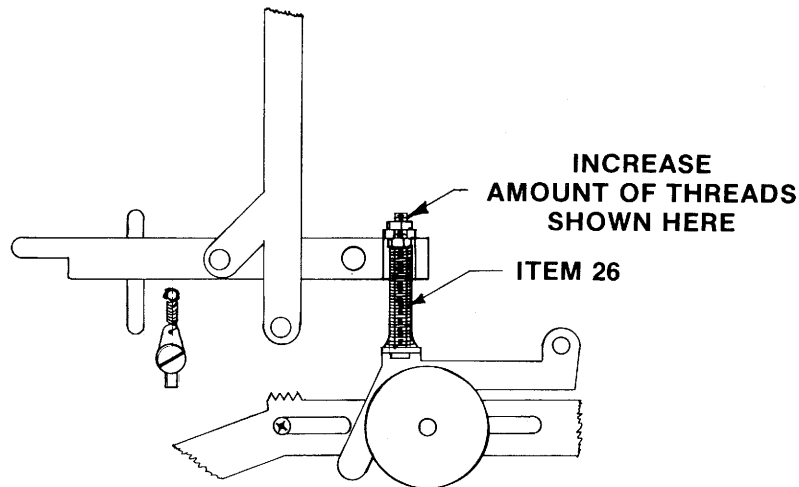

- F. Price wires to low and hit price wheel.
  - 1. Install coinage correctly.
  - 2. Adjust price wire(s) (and) or coinage so price wires will clear as shown.

ILLUSTRATION 2

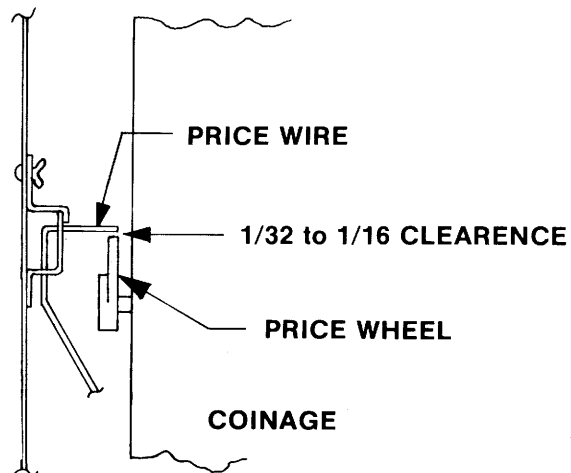

## III. ACCEPTS COINS, WILL ESTABLISH CREDIT, BUT WILL NOT VEND.

- A. Product sold out - load product.
- B. Fast play anti-cheat sticking.
  - 1. Clean grease off Item 22, Page 17 and off end plate to insure free movement.
  - 2. Replace Item 22, Page 17. It may be bent or burred because of cheating.

C. Low price wire dropped ¼" to ½" below top of price wheel (can not free vend by using free play lever)

1. Install coinage correctly.
2. Replace *Item 49, Page 17* (101814) first finger lock-up stake assembly.

#### **IV. VENDS FOR PRICE LOWER THAN PRICE SETTING.**

A. Price setting incorrect.

1. Set price correctly on coinage.
2. For second price, install price change fingers (*See Fig. 2, Page 4*).

B. Wire guide adjusted to far back - Adjust forward over price wheel so price wheel passes price finger 1/16".

C. Credit left on coinage from previous vend - adjust reset assembly to reset coinage sooner.

#### **V. SET FOR DUAL PRICE, SECOND PRICE VENDS FOR FIRST PRICE AMOUNT OF CREDIT.**

A. Second price wire too high.

1. Remove second price tab on price change bar. (*Tab (H) Fig. 2, Page 4*).
2. Adjust second price wire down. (*See second price setting, instructions Page 3*).

B. Price change finger set incorrectly - Set correctly (*See High Price Setting page 3*).

C. Wire guide out of adjustment - Adjust wire guide so second price wire is over price cam with correct amount of credit on coinage for second price.

D. Adjustment Screw (*Bolt D page 4*) holding second price wire loose, blocking price cam on coinage assembly.

#### **VI. ACCEPTS MONEY, GOES THROUGH VEND CYCLE BUT DELIVERS NO PRODUCT. (SHELF DOES NOT DROP).**

A. Trip finger spring is off - Replace trip finger spring.

B. Nudger cam bushing not in pull bar slot - Install stack correctly (*See Page 7 Stack Installation*).

#### **VII. ONE VEND DROPS TWO SHELVES.**

A. End of shelf ear bent - Correct or replace shelf (*Item 7, Page 19*) (*Item 4, Page 21*).

B. Trip portion of shelf locking in stack - Correct or replace shelf. (*Item 7, Page 19*) (*Item 4, page 21*).

#### **VIII. STACK VENDS WITH ALL SHELVES DOWN.**

A. Lock-out bar sticking - Free lock-out bar and check spring (*Items 29 & 33, Page 19*) (*Items 27 & 31, Page 21*).

B. Bottom of lock-out bar not dropping in front of pull bar notch - Adjust angle at top of lock-out bar to 90 degrees. (*Item 29, Page 19*) (*Item 27, Page 21*).

#### **IX. ACCEPTS MONEY, WILL ESTABLISH CREDIT, BUT STACK WILL NOT VEND WITH ALL SHELVES UP.**

A. Top shelf not in correct position - Lock top shelf in correct position.

B. Nudger cam not in pull bar slot - Install stack correctly. (*See page 7 Stack Installation*).

#### **X. FREE VENDING.**

A. Coinage installed incorrectly - Install coin mech correctly. (*See Page 4*).

B. Price wire out of slot - Replace price wire (*See Page 3 & 4*).

C. Rejector reset lever assembly is under reset on coin mech - Install coin mech correctly.

D. Credit on coin mech not being erased - Adjust reset lever *Item 14, Page 17*) by decreasing the number of threads shown (*Item 26, Page 17*).

E. First finger lock-up not locking on control bar.

1. First finger lock-up rubs against finger second lock and does not drop freely - Insert a bladed screwdriver between the finger - second lock and first finger lock-up stake assembly. Bend the first finger lock-up stake assembly away from the finger - second lock. A small amount of lubricant should then be placed on the upper edge of the finger second lock.

**ILLUSTRATION 3**

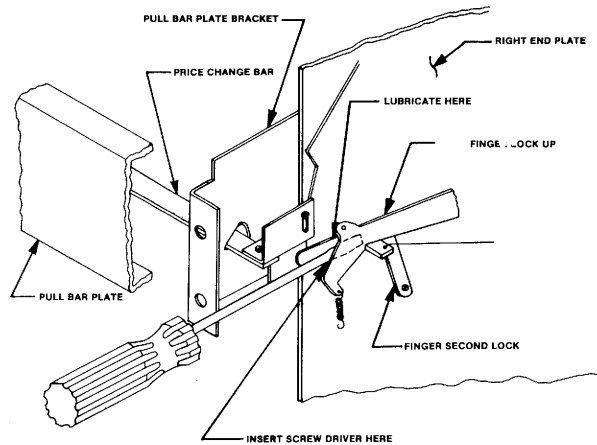

**XI. VEND MORE THAN ONE PRODUCT FOR THE PRICE OF ONE BY RELEASING PULL KNOB SLOWLY AND PULLING AGAIN JUST AS THE RATCHET PAWL CLEARS THE TEETH ON THE RATCHET ASSEMBLY.**

- A. Spring off ratchet pawl - Replace spring (*Item 48 Page 17*).
- B. First finger lock-up rubs against finger - second lock and does not drop freely - Insert a bladed screwdriver between the finger - second lock and first finger lock-up stake assembly. Bend the first finger lock-up stake assembly away from the finger - second lock. A small amount of lubricant should then be placed on the upper edge of the finger second lock.

**XII. PULL BAR WILL NOT RETURN CORRECTLY.**

- A. Rocker arm anti-cheat out of adjustment - Adjust anti-cheat back to clear pull bar fingers.

**ILLUSTRATION 4**

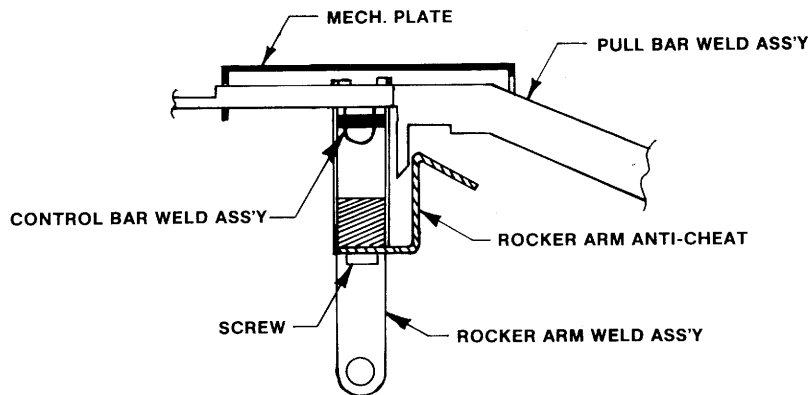

- B. Pull bar rubs pull bar plate - Loosen 4 screw holding pull bar plate, adjust and tighten screws (*Items 42 & 10, Page 15*).

**XIII. VENDS WITH EXCESSIVE FORCE.**

- A. Pull bar rubs against pull bar plate - Loosen 4 screw holding pull bar plate, adjust and tighten screws. (*Items 42 & 10, Page 15*).

**CARE AND CLEANING:**

Disconnect vendor from power source.

Cabinet Exterior: Wash with warm water and soap. Occasionally wax with a good auto wax.

Cabinet Interior: Clear out any foreign particles from delivery box on cabinet. If needed, use a damp sponge and wipe dry.

Windows: Use any type of plastic window cleaner.

**SLUG REJECTOR:**

1. Remove slug rejector from coin mechanism.
2. Soak rejector in warm water and a mild liquid household detergent for approximately ten (10) minutes.
3. Use a stiff paintbrush or toothbrush to clean foreign matter from the rejector.
4. Rinse in clean warm water.
5. Dry thoroughly by shaking or by applying filtered compressed air.

**UNIT FINAL ASSEMBLY  
P/N 101798**

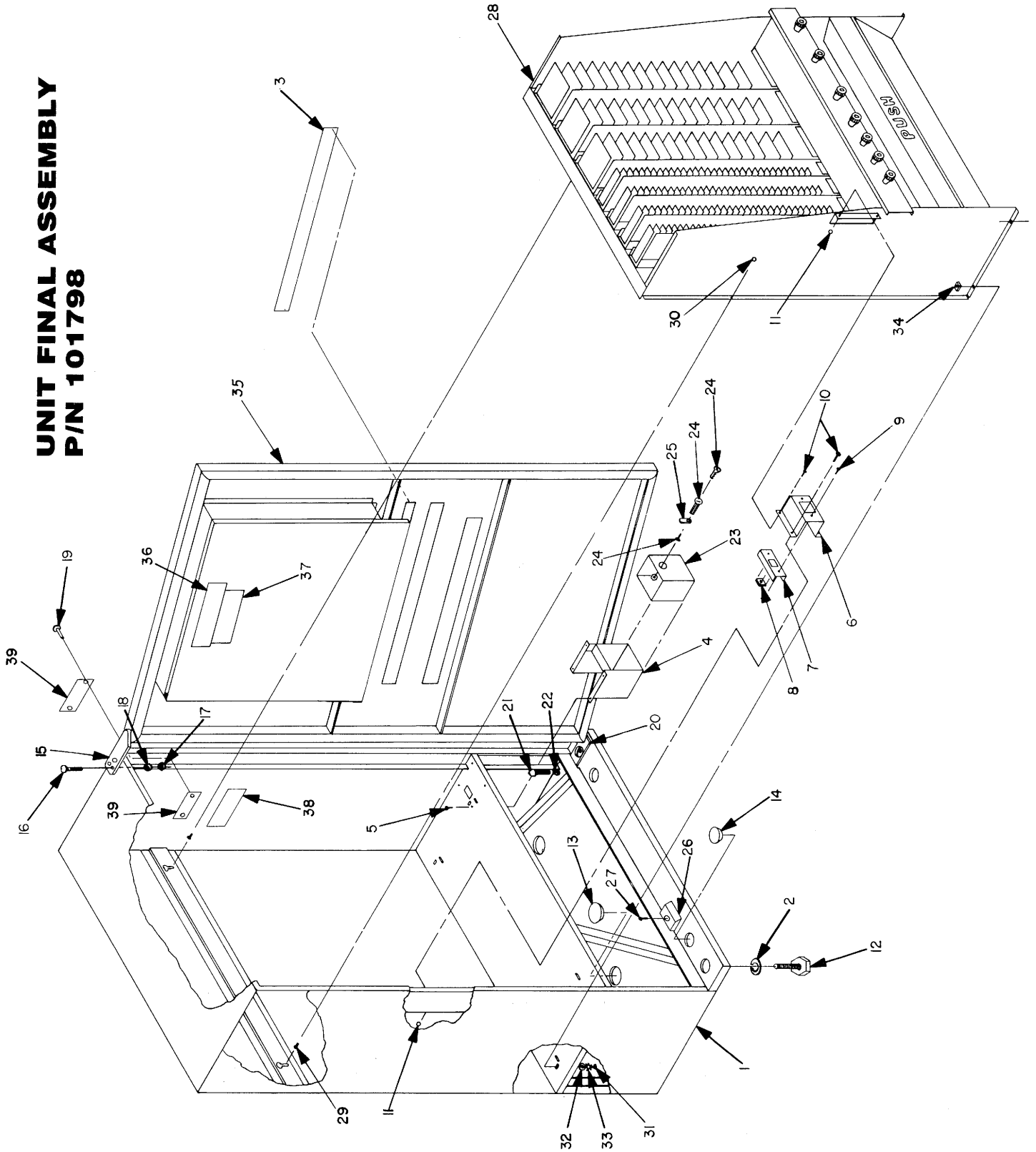

Item	Part No.	No. Req'd	Description
*22	18-6148-000	2	5/16 Lock Washer
*23	101137	1	Coin Box Weld Ass'y.
*24	60318	1	Lock CB46 Key Series
*25	60350	1	Lock Cam
*26	25610	1	Door Glide
*27	50202	1	#8-18 x 1/2 Phil/Hex Washer Hd. Tek
28	101800	1	Mech Final Ass'y. (see page 15)
29	50393	2	1/4-20 x 3/4 Carriage Bolt
30	50531	2	1/4-20 Hex Nut
31	50353	4	1/4-20 x 3/4 Slotted Hex Hd. Bolt
32	50594	4	Flat Washer - 1/4"
33	50593	4	1/4' Ext Shakeproof Lock Washer
34	50535	4	1/4-20 Captive Nut
35	101799	1	Door Final Assembly (see page 13)
36	20054	1	Label-Mech To Be Level
37	20613	1	Caution Label-Shelves
38	20425	1	Patent Label
39	27344-001	2	Rivet
	50371	1	1/4-14 x 3/4 Ind. Hex Washer Hd. Tek
	101725		Complete Coin Box Lock and Cam Ass'y.

Item	Part No.	No. Req'd	Description
1	101785	1	Cabinet Final Ass'y.
	101790	1	Cabinet Weld Ass'y.
	50525	8	Weld Nut 1/2-13
*2	9927	4	Leg Leveler Washer
3	20614-000	1	Selection Label
4	101793	1	Coin Box Housing Weld Ass'y.
*5	50202	4	#8-18 x 1/2 Phil/Hex Washer Hd. Tek
6	7468	1	Lock Nut Brk't.
7	7467	1	Channel - Cage Nut
*8	50760	1	1/2-13 Captive Nut
*9	50202	2	#8-18 x 1/2 Phil/Hex Washer Hd. Tek
*10	50240	4	#8-32 x 3/8 Phil Pan Hd. Mach Screw
*11	50494	4	#8-32 Unitorque Nut
*12	60310	4	Leg Levelers
*13	25-0135-002	2	Hole Plug 1"
14	25-0135-003	4	Hole Plug 3/4"
*15	101127	1	Upper Hinge Ass'y.
*16	50099	3	5/16-18 x 3/4 Carriage Bolts
*17	50066	3	5/16 Hex Nut Plttd.
*18	18-6148-000	3	5/16 Lock Washer Plttd.
*19	50667	2	Rivet
*20	60-0018-000	1	Lower Hinge Ass'y.
*21	50072	2	5/16-18 x 3/4 Hex Hd. Bolt

**DOOR FINAL ASSEMBLY  
P/N 101799**

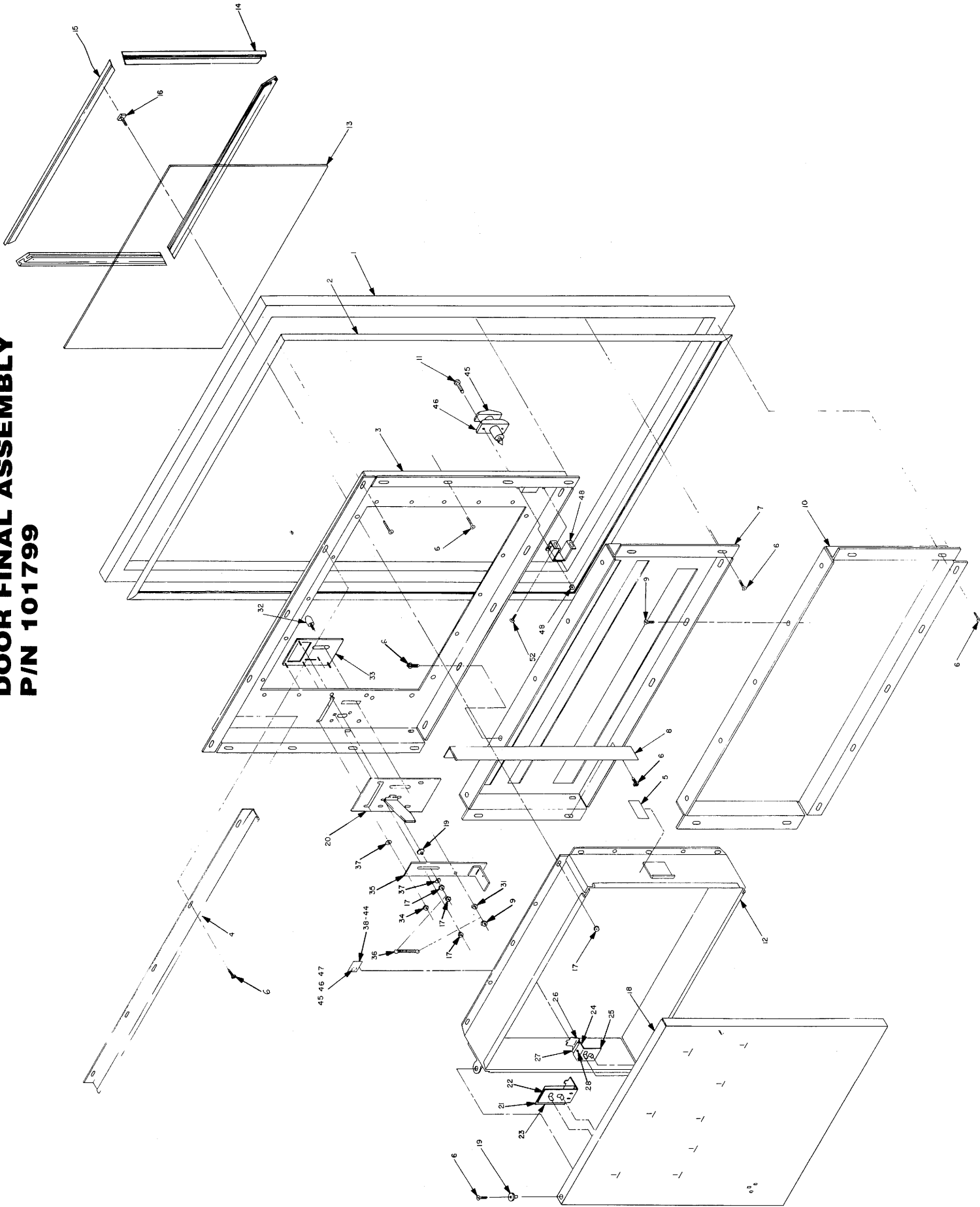

Item	Part No.	No. Req'd	Description
*30	60328-x	1	Lock Cylinder W/2 Keys Keys Series 60328-1 LAN 1 60328-6 LAN 6 60328-2 LAN 2 60328-7 LAN 7 60328-3 LAN 3 60328-8 LAN 8 60328-4 LAN 4 60328-9 LAN 9 60328-5 LAN 5 60328-10 LAN 10
31	50495	1	#10-32 Unitorque Nut
32	30359	1	Coin Reject Knob
33	20611-000	1	Coin Insert Decal
*34	101566	1	Coin Insert Plate Weld Ass'y.
35	50513	1	#8-32 Twin Whiz Lock Nut
36	101826	1	Coin Reject Slide Weld Ass'y.
37	21015	1	Spring - Coin Reject Slide
38	50575	1	Watkins Washer
39	20612-001	1	Item Tag #1
40	20612-002	1	Item Tag #2
41	20612-003	1	Item Tag #3
42	20612-004	1	Item Tag #4
43	20612-005	1	Item Tag #5
44	20612-006	1	Item Tag #6
45	20622	7	Item Tag #7
*46	20689	7	Price Labels 25¢
*47	20708	7	Price Labels 30¢
48	9823	7	Price Labels 35¢
	30377	1	Lock Housing
			Spacer - Coin Reject Knob

Item	Part No.	No. Req'd	Description
1	101716	1	Door Frame Weld Ass'y.
2	60381	1	Door Gasket
3	7452	1	Top Door Panel
4	6967	1	Door Anti-Cheat-Top
5	20617	1	Label Display Door
*6	50202	AS REQ'D	#8-18 x 1/2 Phil/Hex Washer Hd. Tek
7	7453	1	Middle Door Panel
8	6959	1	Door Anti-Cheat Side
*9	50546	2	#10-32 Twin Whiz Lock Nut
10	101829	1	Bottom Door Panel Screen Ass'y.
*11	50338	2	#10-32 x 1/2 Phil Flat Head M.S.
12	101788	1	Shadow Box Side Weld Ass'y.
13	25613	1	Display Window
14	22366-000	2	Display Trim-Side
15	22366-001	2	Display Trim-Top & Bottom
*16	50724	AS REQ'D	#8-32 x 3/8 "T" Bolt
*17	50513	AS REQ'D	#8-32 Twin Whiz Lock Nut
18	101830	1	Shadow Box Door Screen Ass'y.
19	30053	1	Shoulder Bushing
20	102049	1	Coin Insert Backing Plate Weld Ass'y.
21	101823	4	Bar Type Product Hanger Ass'y.
22	7455	1	Product Hanger - Bar Type
23	21079	1	Product Retaining Wire
24	101824	3	Bag Type Product Hanger Ass'y.
25	6961	1	Bracket - Product Hanger
26	7454	1	Product Hanger - Bag Type
27	60118	1	Bulldog Clip
28	50420	1	#8-32 x 1/4 Ind. Wash. Phil/Hex Hd. Type "B" S.M.S.
*29	60321	1	4255-19 Flush Handle Lock (Without Cyl. or Keys)
	50555	1	1/2 Retainer Ring
	8694-xxx	1	Washer - Door Lock
	8694-000		.0359 Thick
	8694-001		.030 Thick
	8694-002		.0209 Thick

**MECH FINAL ASSEMBLY  
P/N 101800**

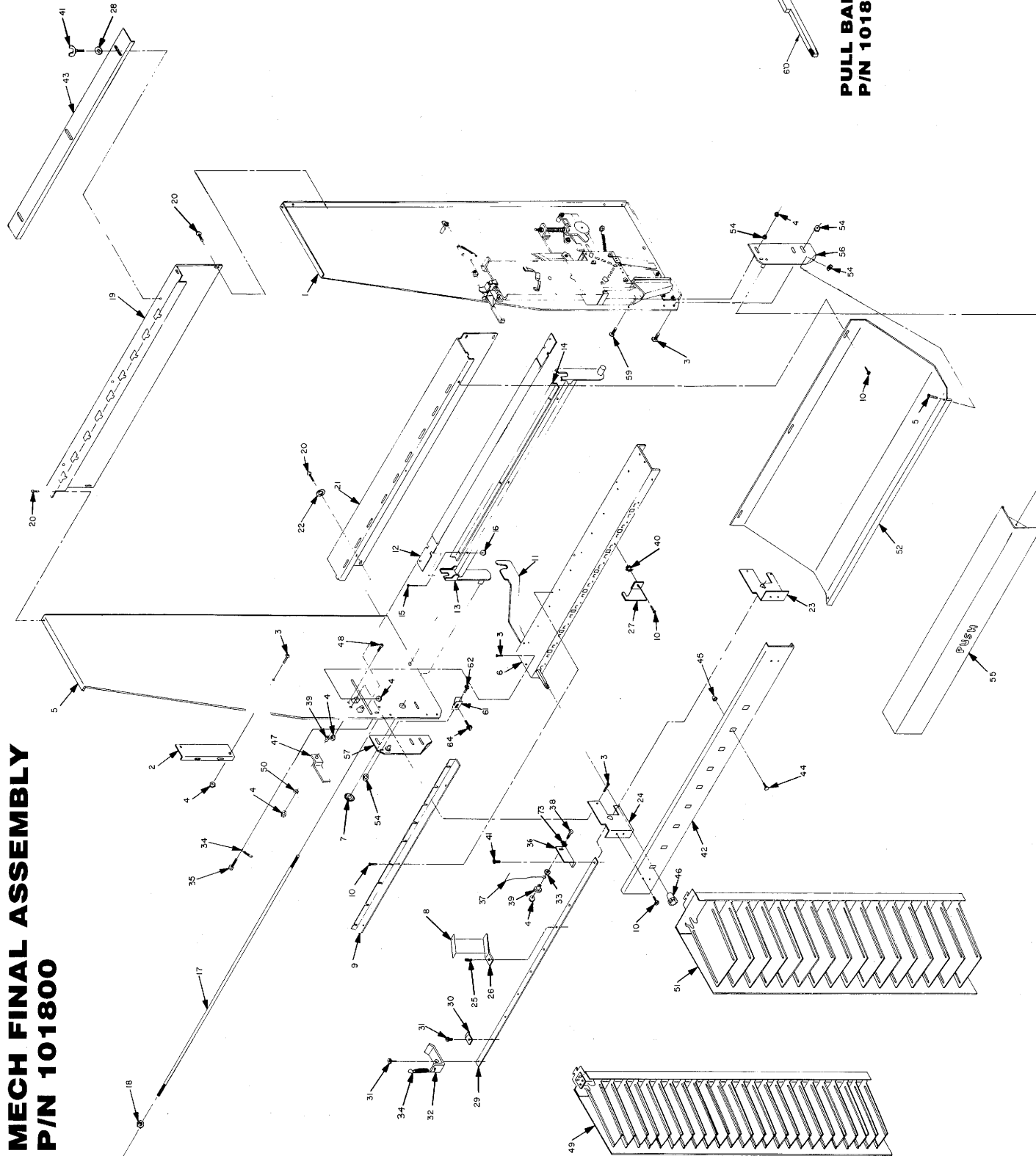

**PULL BAR RIVET ASSEMBLY  
P/N 101857 (SERVICE PART)**

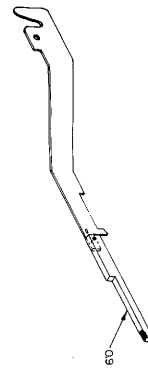



Item	Part No.	No. Req'd	Description
34	21024	1	Spring
35	50426	1	#10 x 1/4 Ind. Hex Hd. Phil Type "B" S.M.S.
36	7474	1	Brk't. - 2nd Price
37	21078	1	Second Price Control Wire
38	50249	1	#8-32 x 1/2 Hex Hd. M.S.
39	30053	1	Shoulder Bushing
40	50585	2	#8 External Shakeproof Lock Washer
41	50360	3	1/4-20 x 1/2 Wing Screw Type 60
42	7462	1	Pull Bar Plate
43	6950	1	Bracket - Stack Hold Down
44	20-1487-000	2	1/4-20 x 1/2 Carriage Bolt
45	50490	2	1/4 Palnut
46	30205	7	Pull Bar Knob
47	6969	1	Bracket - Second Price Lift
*48	50247	1	#8-32 x 1/2 Phil Pan Hd. M.S.
49	101803	4	Stack Final Ass'y. - Narrow (see page 19)
50	50575	1	Flat Washer
51	101802	3	Stack Final Ass'y. - Wide (see page 21)
52	7478	1	Delivery Pan
53	20-0469-003	2	#8-32 x 3/8 Phil Truss Hd. M.S.
*54	50513	2	#8-32 Twin Whiz Lock Nut
55	101794	1	Delivery Door - Weld Ass'y.
56	101795-000	1	Delivery Pan Brk't. Stake Ass'y. - Right
57	101795-001	1	Delivery Pan Brk't. Stake Ass'y. - Left
58	6958	1	Stop Delivery Door
*59	50251	1	Stop Delivery Door

Note: When replacing item No. 11 use the following Assy. 101857

60 101857 1 Pull Bar Rivet Ass'y.

Item	Part No.	No. Req'd	Description
1	101805	1	Right End Plate Ass'y. (see page 17)
2	6962	1	Brk't. - Lock Channel Mtg.
*3	50240	AS REQ'D	#8-32 x 3/8 Phil Pan Hd. M.S.
*4	50494	AS REQ'D	#8-32 Unitorque Nut
5	6944-001	1	End Plate - Left
6	101813	1	Mech Plate Stake Ass'y.
7	50566	1	Cap - Type Push-on
8	20631	1	Label - 2nd Price Instruction
9	7475	1	Brk't. - Stack Aligning
*10	50202	AS REQ'D	#8-18 x 1/2 Phil/Hex Washer Hd. Tek
11	101789	7	Pull Bar Weld Ass'y.
12	101787	1	Control Bar Weld Ass'y.
13	101786	1	Rocker Arm Weld Ass'y.
14	6938	1	Rocker Arm Anti Cheat
15	50344	3	#10-32 x 1" Phil Rd. or Pan Hd. M.S.
16	50495	3	#10-32 Unitorque Nut
17	30088	1	Tie Rod
*18	50546	3	#10-32 Twin Whiz Lock Nut
19	7486	1	Top Back Brace
20	50447	4	14 x 1/2 Hex Hd. Crimpstite S.M.S.
21	7479	1	Bottom Back Brace
23	7477-000	1	Pull Bar Plate Brk't. - Right
24	7477-001	1	Pull Bar Plate Brk't. - Left
25	50305	AS REQ'D	#10-32 x 5/16 Phil. Fillister Hd.
26	8054	1	Second Price Lock Out
27	7469	2	Brk't. - 2nd Price Bar Support
28	50618	3	1/4 Fender Washer
29	7476	1	Price Change Bar
30	7470	4	2nd Price Finger
31	50305	4	#10-32 x 5/16 Phil Fillister Hd.
32	7471	1	Brk't. - 2nd Price Spring
33	50575	1	Flat Washer

# RIGHT END PLATE ASSEMBLY P/N 101805

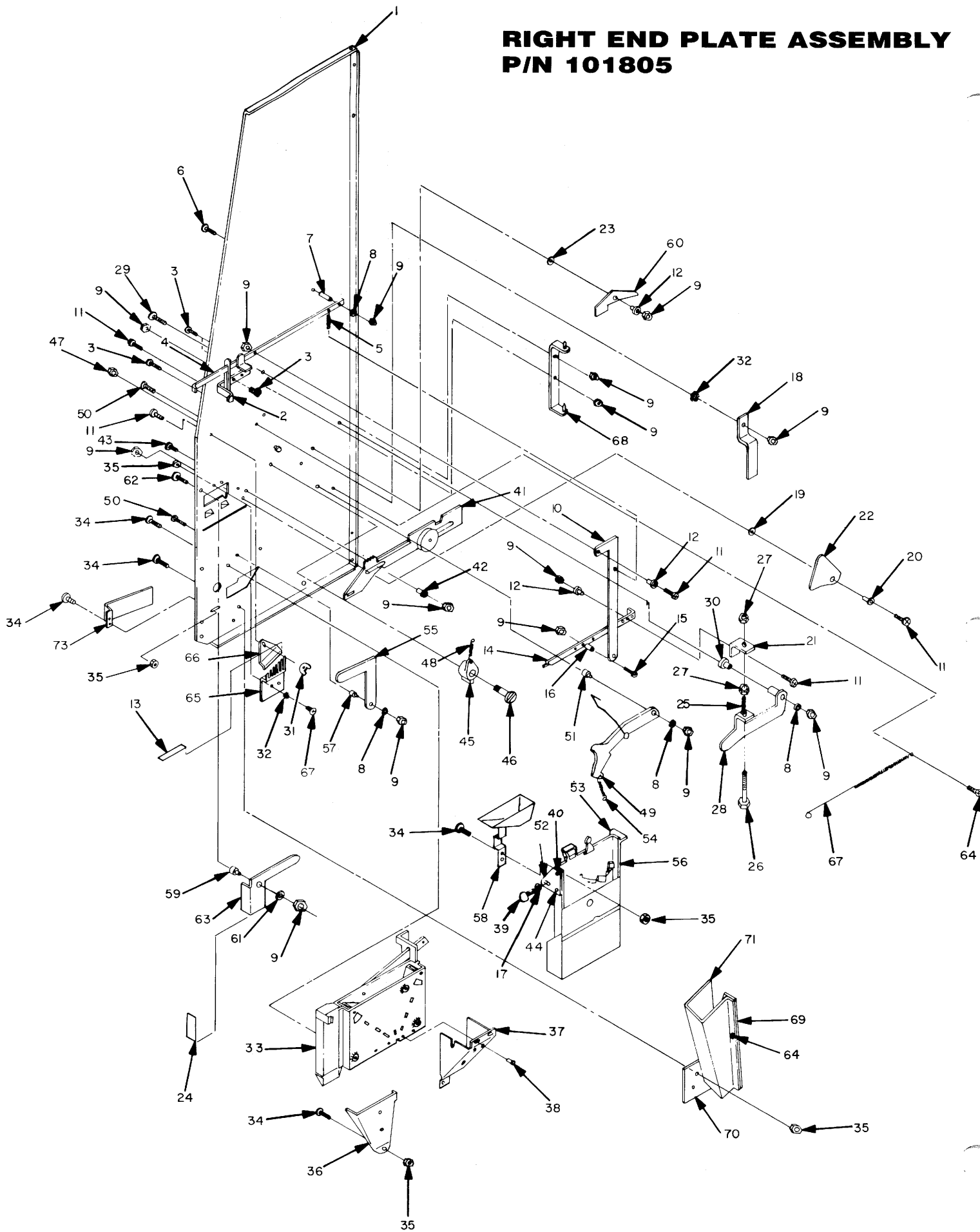

Item	Part No.	No. Req'd	Description
1	6944-000	1	End Plate - Right
2	100452	1	Rejector Arm Stop Ass'y.
3	50240	AS REQ'D	#8-32 x 3/8 Phil. Pan Hd. M.S.
4	100123	1	Rejector Arm Ass'y.
5	21005	1	Spring
6	50295	1	#8-32 x 1 1/2 Phil Rd. Hd. M.S.
7	30080	1	Spacer
8	50575	AS REQ'D	Flat Washer
*9	50494	AS REQ'D	#8-32 Unitorque Nut
10	100564	1	Vertical Rejector Link Ass'y.
11	50247	AS REQ'D	#8-32 x 1/2 Phil Pan Hd. M.S.
12	30053	2	Shoulder Bushing
13	20049	1	Coinage Selection Label
14	100218	1	Rejector Reset Lever Ass'y.
15	50273	1	#8-32 x 1" Phil Pan Hd. M.S.
16	30079	1	Spacer
17	50624	1	Washer, Brass
18	6717	1	Reset Lever Guide
19	50609	1	Flat Washer
20	30050	1	Stack Holding Arm Bushing
21	6716	1	Reset Lever Angle
22	6975	1	Flast Play Anti Cheat
23	50609	1	Flat Washer
24	20618	1	Label-Free Play Lever
25	21046	1	Rejector Reset Spring
26	50386	1	1/4-20 x 3/4 Hex Hd. Bolt
27	50496	2	1/4-20 Unitorque Nut
28	101808	1	Reset Cam Stake Ass'y.
29	50286	1	#8-32 x 1 1/4 Phil Rd. Hd. M.S.
30	30002	1	Reset Inner Bushing
31	50514	1	#8-32 Wing Nut
32	50585	1	#8 External Shakeproof Lock Washer
33	101815	1	Escrow Box Ass'y. (see page 23)
34	20-0469-003	5	#8-32 x 3/8 Phil Truss Hd. M.S.
*35	50513	1	#8-32 Twin Whiz Lock Nut
36	100754	1	SCS Coin Return Pocket Ass'y.
37	5431	1	Escrow Return Pocket
38	50663	2	Pop Rivet
39	50339	1	#10 x 32 x 3/8 Thumb Screw
40	50204	1	#8 x 32 x 1/4 Phil Pan Hd. M.S.
41	101816	1	Ratchet Ass'y.
42	30355	2	Ratchet Slide Bushing
*43	50251	2	#8-32 x 5/8 Phil Pan Hd. M.S.
44	20-0469-006	1	#6 x 32 x 1/4 Phil R.D. Hd. M.S.
45	6483	1	Ratchet Pawl
46	30038	1	Ratchet Pawl Stud
47	50495	1	#10-32 Unitorque Nut
48	21021	1	Ratchet Pawl Spring
49	101814	1	First Finger Lock-up Stake Ass'y.
50	50263	1	#8-32 x 7/8 Phil Pan Hd. M.S.
51	30372	1	Lock-up Finger Bushing
52	4693	1	Brk't. - Rejector Hold Down
53	7457	1	Bracket - Rejector Hanger
54	21024	1	Spring
55	7456	1	Finger - Second Lock
56	101861	1	Complete Coinage Ass'y. (see page 24 & 25)
57	30356	1	2nd Lock Finger Bushing
58	100249	1	Coin Chute Weld Ass'y.
59	30008	1	Shoulder Bushing
60	7451	1	Finger - Mech. Lock-up
61	50575	1	#8-32 Flat Washer
62	50262	1	#8-32 x 3/4 Phil. Pan Hd. M.S.
63	6973	1	Free Play Lever
64	50202	AS REQ'D	#8-18 x 1/2 Phil Hex Washer Hd. Tek
65	5408	1	Wire Guide
66	5437	1	Wire Retainer
67	21039	2	Control Bar Spring
68	101804	1	Coin Mech. Mtg. Brk't Weld Ass'y.
69	101807	1	Coin Chute Ass'y.
70	6952	1	Bracket - Coin Chute
71	6953	1	Coin Chute
73	4449	1	Escrow Anti-Cheat

**STACK FINAL  
- NARROW  
P/N 101803**

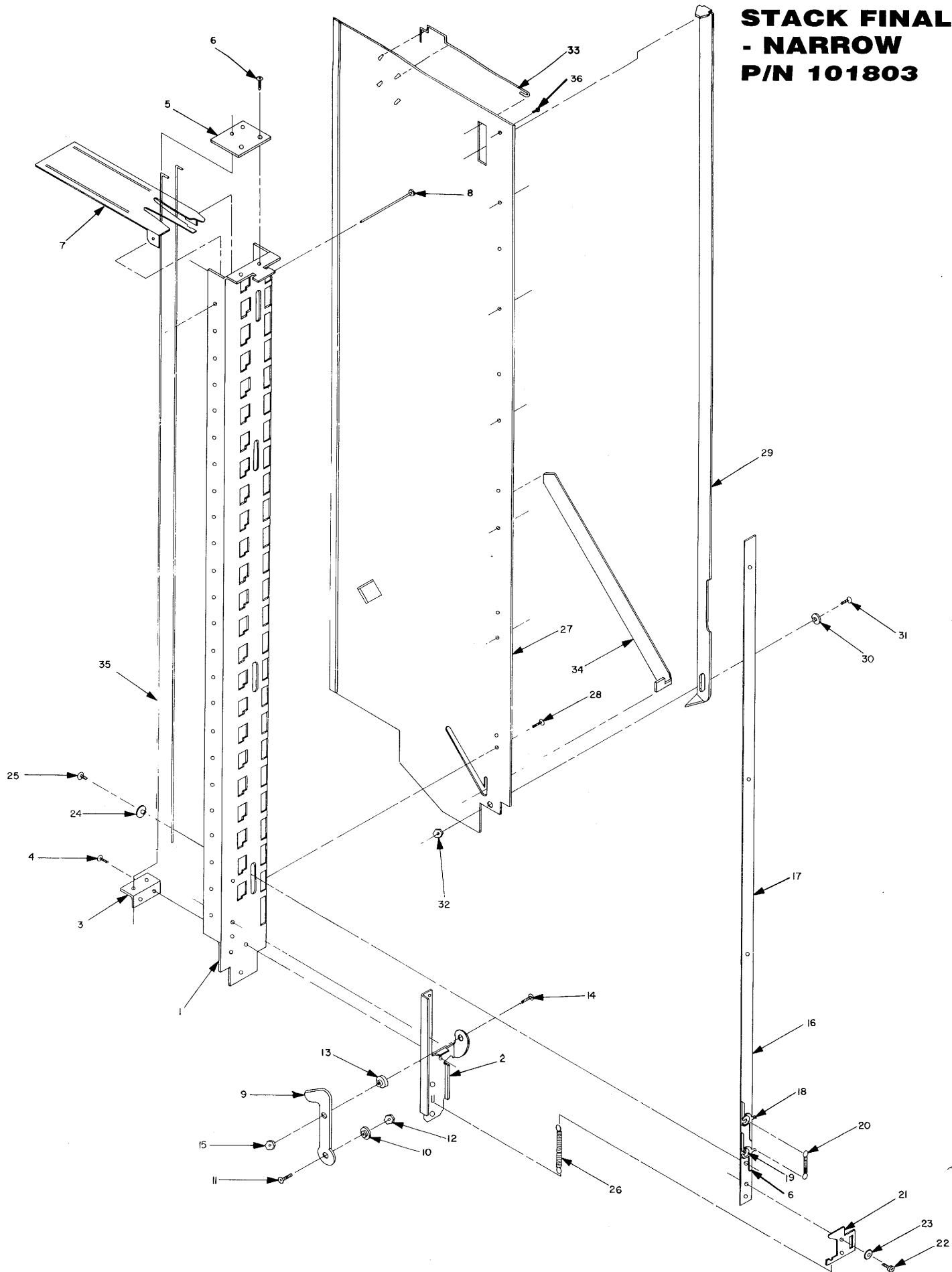

Item	Part No.	No. Req'd	Description
1	7483	1	Stack - Narrow
2	5839	1	Bottom Stack Bracket
3	5949	1	Bottom Stack Rod Bracket
*4	50202	6	#8-18 x 1/2 Phil/Hex Washer Hd. Tek
5	5947	1	Top Stack Rod Bracket
6	8048	1	Trip Finger (First)
7	5840	24	Shelf - Narrow
8	30103	24	Shelf Hinge Pin - Narrow
9	6701	1	Nudger Cam
10	30013	1	Connection Pin
11	50337	1	#10-32 x 5/8 Phil Pan or Rd. Hd. M.S.
12	50495	1	#10-32 Uunitorque Nut
13	30089	1	Nudger Cam Hinge Bushing
*14	50251	1	#8-32 x 5/8 Phil Pan Hd. M.S.
*15	50494	1	#8-32 Uunitorque Nut
16	101818	1	Nudger Bar Rivet Ass'y.
17	8357	1	Nudger Bar
18	5818	22	Trip Finger
19	50660	23	Trip Finger Rivet
20	21027	12	Candy Shelf Spring
21	6700	1	First Finger
22	50305	2	#10-32 x 5/16 Phil Fillister Hd.
23	50589	2	#10 Int. Shakeproof Lock Washer
24	30100	4	Stack Spacer Bushing
25	50226	4	#8-32 x 1/4 Phil Truss Hd.
26	21015	1	Coin Reject Slide Spring
27	7458	1	Stack Side Plate
*28	50180	6	#8-18 x 1/2 Phil Pan Hd. Tek
29	8360	1	Lock-Out Bar
30	30010	1	Shoulder Bushing
31	50113	1	#6-32 x 1/2 Phil Pan Hd. M.S.
32	50493	1	#6-32 Uunitorque Nut
33	21026	1	Empty Lock Spring
34	6970	1	Shelf Lift
35	8359	2	Stack Wire
36	50212	1	#8-32 x 1/4 Pan Hd. Self Tap Type 23

**STACK FINAL - WIDE**  
**P/N 101802**

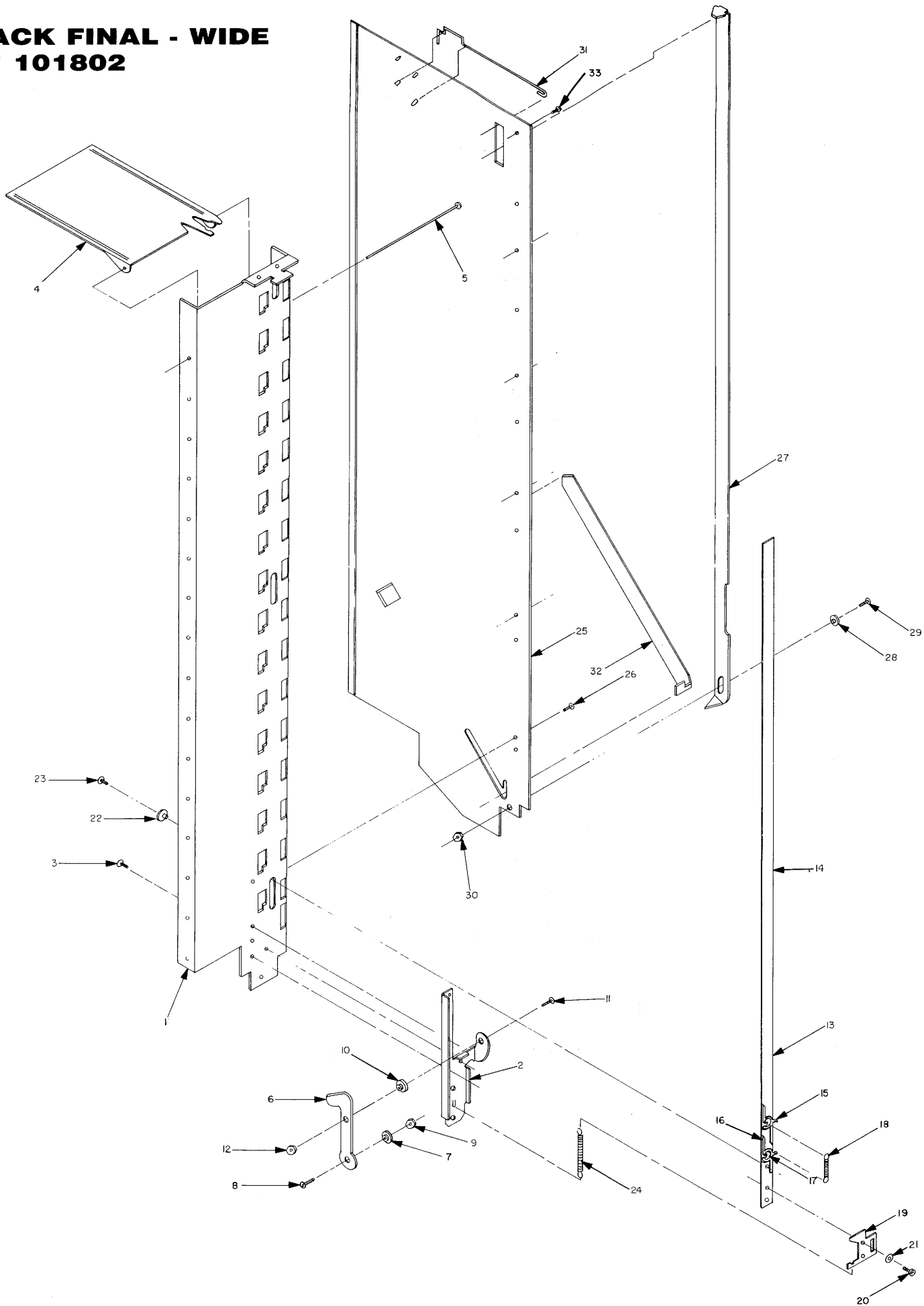

Item	Part No.	No. Req'd	Description
1	7464	1	Stack - Wide
2	5839	1	Bottom Stack Bracket
*3	50202	4	#8-18 x 1/2 Phil/Hex Washer Hd. Tek
4	9711	16	Shelf - Wide
5	30357	16	Shelf Hinge Pin - Wide
6	6701	1	Nudger Cam
7	30013	1	Connection Pin
8	50337	1	#10-32 x 5/8 Phil Pan or Rd. Hd. M.S.
9	50495	1	#10-32 Uunitorque Nut
10	30089	1	Nudger Cam Hinge Bushing
*11	50251	1	#8-32 x 5/8 Phil Pan Hd. M.S.
*12	50494	1	#8-32 Uunitorque Nut
13	101819	1	Nudger Bar Rivet Ass'y.
14	6964	1	Nudger Bar
15	7740	14	Trip Finger
16	7798	1	Trip Finger
17	50660	15	Trip Finger Rivet
18	21042	8	Candy Shelf Spring
19	6700	1	First Finger
20	50305	2	#10-32 x 5/16 Phil Fillister Hd.
21	50589	2	#10 Int. Shakeproof Lock Washer
22	30100	3	Stack Spacer Bushing
23	50226	3	#8-32 x 1/4 Phil Truss Hd.
24	21015	1	Coin Reject Slide Spring
25	7458	1	Stack Side Plate
*26	50180	5	#8-18 x 1/2 Phil Pan Hd. Tek
27	7482	1	Lock-Out Bar
28	30010	1	Shoulder Bushing
29	50113	1	#6-32 x 1/2 Phil Pan Hd. M.S.
30	50493	1	#6-32 Uunitorque Nut
31	21026	1	Empty Lock Spring
32	6970	1	Shelf Lift
33	50212	1	#8-32 x 1/4 Phil/Pan Hd. Type 23 Self Tap

# ESCROW BOX ASSEMBLY P/N 101815

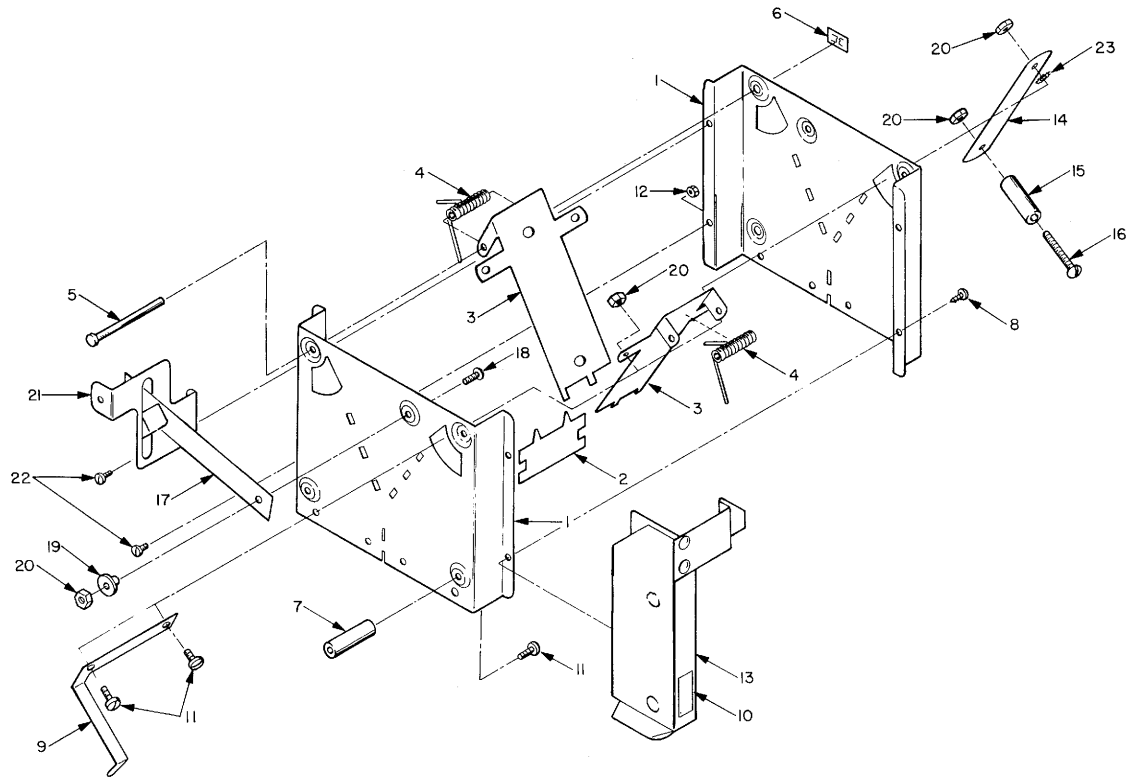

Item	Part No.	No. Req'd	Description
1	5406	2	Escrow Shell
2	5430	1	Escrow Coin Divider
3	5407	2	Escrow Flapper
4	21019	2	Escrow Flapper Spring
5	30107	2	Escrow Flapper Pin
6	50561	2	Tinnerman Push-On
7	30006	2	Escrow Stud
8	50120	2	#6-32 Phil Pan Hd. Type 23 S.T.S.
9	7472	1	Flapper Control
10	20060	1	Patent Label
11	50247	2	#8-32 x 1/2 Phil Pan Hd. M.S.

Item	Part No.	No. Req'd	Description
12	50505	2	#6-32 Twin Whiz Nut
13	100208	1	Overflow Channel Ass'y.
14	21029	1	Escrow Spring
15	30150	1	Escrow Spring Weight
16	50286	1	#8-32 x 1 1/4 Phil Rd. Hd. M.S.
17	100207	1	Escrow Reject Arm Ass'y.
18	50244	1	#8-32 x 1/2 Phil Truss Hd. M.S.
19	30053	1	Shoulder Bushing
20	50494	2	#8-32 Unitorque Nut
21	5427	1	Anti-Cheat Guide
22	50112	2	#6-32 x 1/4 Phil Pan Hd. M.S.
23	50585	1	#8 Shakeproof Lock Washer



# SCS MODULE FRONT VIEW

**COMPLETE SCS MECH  
P/N 60382**

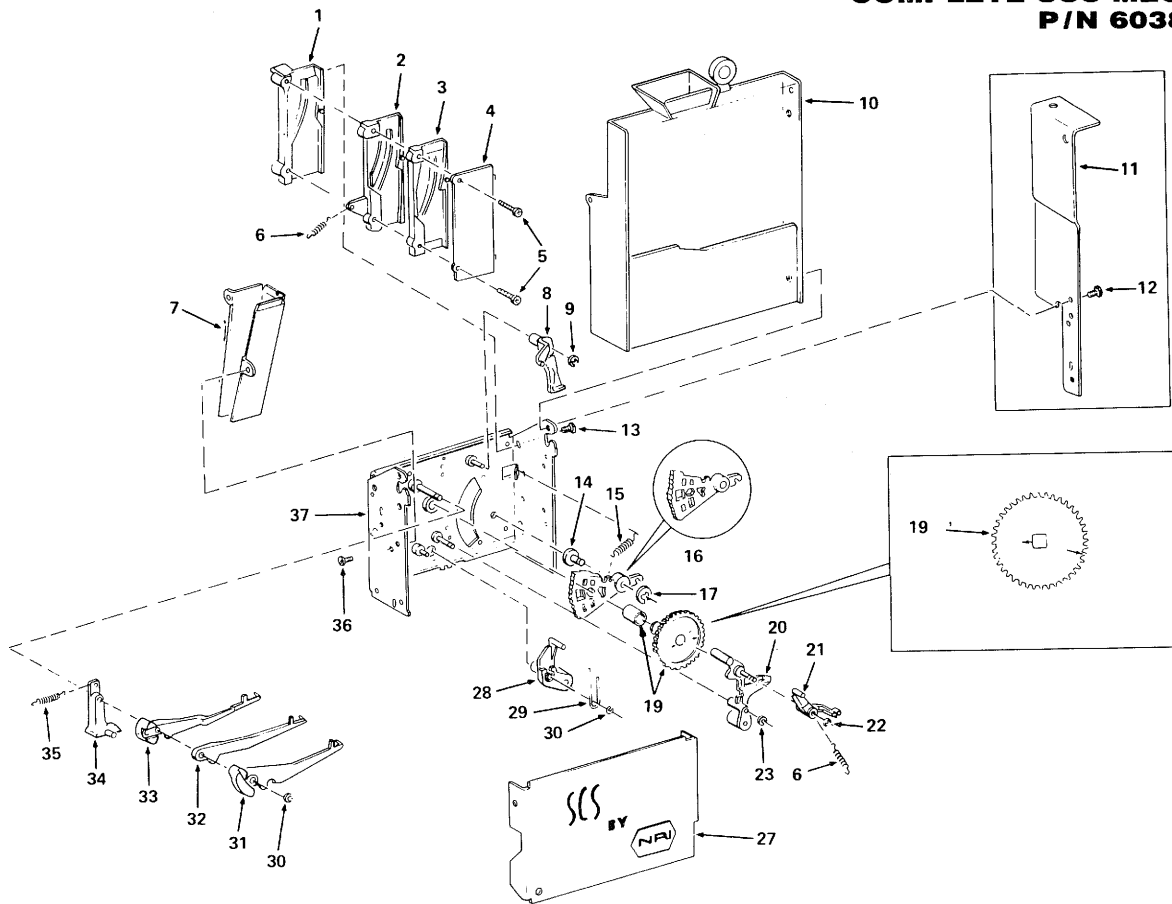

Part No.	No. Req'd	Description	Item	Part No.	No. Req'd	Description
13496-9	1	Chute, 25¢ Coin	19	15897-1	1	Credit Gear & Sleeve
13494-6	1	Chute, 10¢ Coin	20	13548-1	1	Advance Lever Assembly
13495-10	1	Chute, 5¢ Coin	21	13484-1	1	Variable Pawl
13493-10	1	Cover, 5¢ Chute	22	8959-8	1	Retaining Ring
13526-6	2	Screw, #6 x 1" Sheet Metal	23	8959-11	1	Retaining Ring
13536	1	Spring, Variable Pawl				
17593	1	Chute, Coin Return				
13531-1	1	Stop Assembly, 10¢	27	13516	1	Coverplate, Front
8959-8	1	Retaining Ring	28	13653-2	1	Lever Assembly, Anti-Cheat
01-15-022	1	Rejector	29	13647	1	Spring, Anti-Cheat
14173-3	1	Bracket, Rejector Mounting	30	8959-11	2	Retaining Ring
9481-8	1	Screw, #8-32 x 1/4 R.H. Sems	31	19622-1	1	Actuator Assembly, 5¢
13526	2	Screw, #8 x 3/8 Sheet Metal	32	19621-1	1	Actuator, 10¢
13520	1	Pivot Pin, Reset Gear	33	19622	1	Actuator Assembly, 25¢
15535	1	Spring Reset Gear (Silver)	34	13487	1	Holding Pawl
13489-2	1	Reset Gear	35	13767	1	Spring, Pawl
8959-4	1	Retaining Ring	36	13526-3	2	Screw, #6 x 5/16 Sheet Metal
			37	14211-14	1	Channel Assembly

# SCS MODULE REAR VIEW

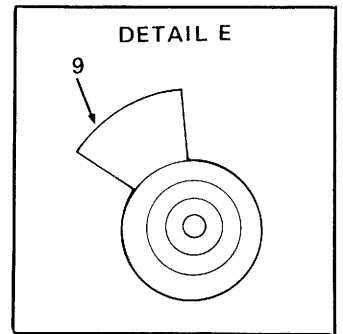
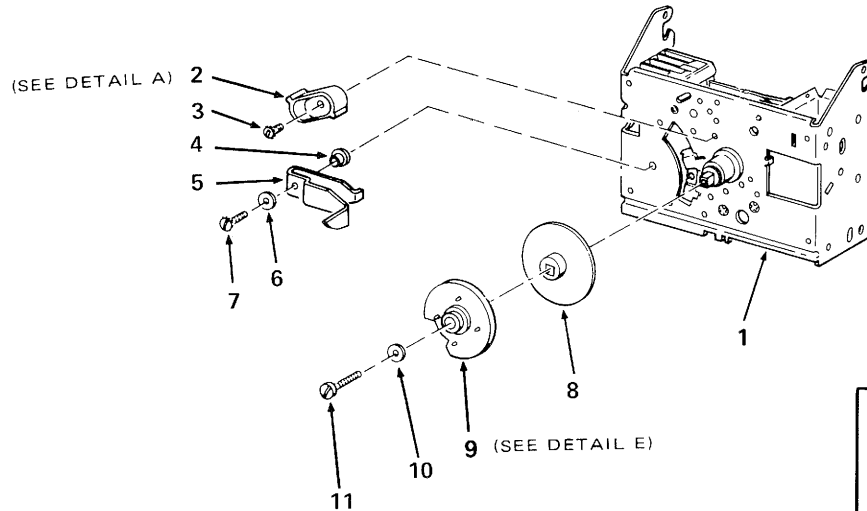
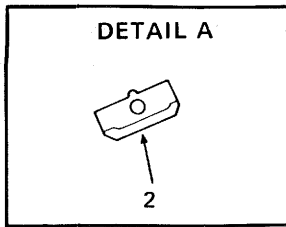

Item	Part No.	No. Req'd	Description
1	14211-14	1	Channel Assembly
2	17907	1	Stop, Price Setting
3	9482-4	1	Screw, #6-32 x 1/4 Truss Hd. Sems.
4	17588	1	Bushing, Reset
5	17591	1	U-Lever
6	8773-78	1	Washer, #8
7	9481-33	1	Screw, #8-32 x 5/8 R.H. Sems
8	17590	1	Hub, Cam 5¢ - \$1.50 (5¢ Increments)
9	17592	1	Cam, Price
10	8773-78	1	Washer, #8
11	13526-1	1	Screw, #8 x 1/2 Sheet Metal
12	17587	1	Cam Stop (Metal Plate - Not Shown)
13	9481-1	2	Screw, #6-32 x 3/16 R.H. Sems (For Item No. 12)

# NOTES

